

# Dealer's Manual

ROAD	GRAVEL	MTB
E-BIKE	LIFESTYLE	GENERAL

# Shifter

## SHIMANO CUES

SL-U8000-L

SL-U8000-IL

SL-U8000-11R

SL-U8000-11IR

SL-U6000-L

SL-U6000-11R

SL-U6000-10R

SL-U4010-9R

SL-U4000-L

SL-U4000-9R

---

## Contents

<b>IMPORTANT NOTICE.....</b>	<b>3</b>
<b>TO ENSURE SAFETY.....</b>	<b>4</b>
<b>List of tools to be used .....</b>	<b>7</b>
<b>Installation/removal .....</b>	<b>8</b>
Installing the shifter.....	8
<b>Adjustment.....</b>	<b>11</b>
Adjusting the stopped lever position (RAPIDFIRE PLUS MONO lever) .....	11
<b>Maintenance.....</b>	<b>13</b>
Replacing the inner cable .....	13
Replacing the cover .....	18



# IMPORTANT NOTICE

- This dealer's manual is intended primarily for use by professional bicycle mechanics.  
Users who are not professionally trained for bicycle assembly should not attempt to install the components themselves using the dealer's manuals.  
If any part of the information on the manual is unclear to you, do not proceed with the installation. Instead, contact your place of purchase or a distributor for assistance.
- Make sure to read all manuals included with each product.
- Do not disassemble or modify the product other than as stated in the information contained in this dealer's manual.
- All manuals and technical documents are accessible online at <https://si.shimano.com> .
- For consumers who do not have easy access to the internet, please contact a SHIMANO distributor or any of the SHIMANO offices to obtain a hardcopy of the user's manual.
- Please observe the appropriate rules and regulations of the country, state or region in which you conduct your business as a dealer.

**For safety, be sure to read this dealer's manual thoroughly before use, and follow it for correct use.**

The following instructions must be observed at all times in order to prevent personal injury and physical damage to equipment and surroundings.

The instructions are classified according to the degree of danger or damage which may occur if the product is used incorrectly.

 <b>DANGER</b>	Failure to follow the instructions will result in death or serious injury.
 <b>WARNING</b>	Failure to follow the instructions could result in death or serious injury.
 <b>CAUTION</b>	Failure to follow the instructions could cause personal injury or physical damage to equipment and surroundings.

# TO ENSURE SAFETY

## **WARNING**

- Be sure to follow the instructions provided in the manuals when installing the product.  
Only use SHIMANO genuine parts. If a component or replacement part is incorrectly assembled or adjusted, it can lead to component failure and cause the rider to lose control and crash.
-  Wear approved eye protection while performing maintenance tasks such as replacing components.

**NOTICE**

Be sure to also inform users of the following:

- Be sure to keep turning the crank arm during the shifter operation.
- If gear shifting operation does not feel smooth, consult the place of purchase for assistance.
- Products are not guaranteed against natural wear and deterioration from normal use and aging.
- For maximum performance we highly recommend SHIMANO lubricants and maintenance products.

For installation to the bicycle and maintenance

- Grease with SIS SP41 Grease (Y04180000) the inner cable and the sliding portions of the outer casing before use to ensure that they slide properly.
- Use an OT-SP41 cable and a cable guide (SM-SP17 / SP18) for smooth operation.
- A special grease is used for the gear shifting cable. Do not use Premium Grease or other types of grease, otherwise, they may cause deterioration in gear shifting performance.
- Use an outer casing which still has some length to spare even when the handlebars are turned all the way to either side. Furthermore, check that the shifter does not touch the bicycle frame when the handles are turned all the way.
- If gear shifting adjustments cannot be carried out, check the alignment of the derailleur hanger and check if the cable is lubricated or if the outer casing is too long or too short.
- List of cables used

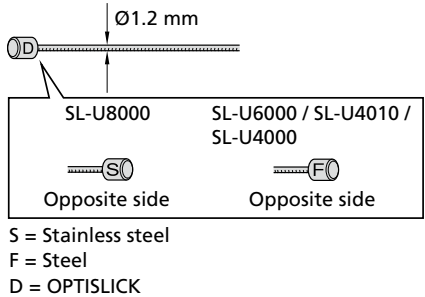
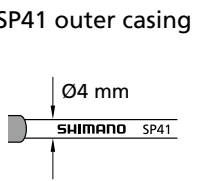
Designated inner cable	Recommended outer casing
 <p> <math>\varnothing 1.2 \text{ mm}</math>            SL-U8000      SL-U6000 / SL-U4010 / SL-U4000            Opposite side      Opposite side            S = Stainless steel            F = Steel            D = OPTISLICK         </p>	 <p>           SP41 outer casing  <math>\varnothing 4 \text{ mm}</math>            SHIMANO SP41         </p>

- \* Refer to the list of recommended outer caps.
- \* Do not let dust adhere on the inner cable. If the grease on the inner cable is wiped off, the application of SIS SP41 Grease (Y04180000) is recommended.
- List of recommended outer caps

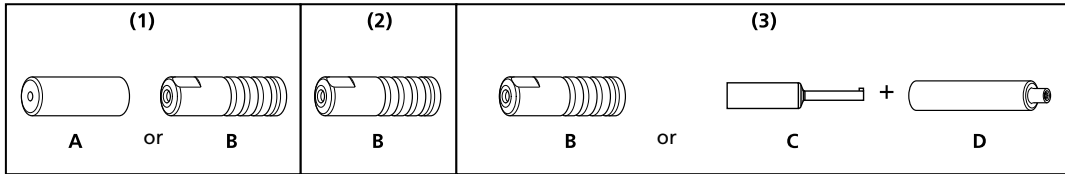
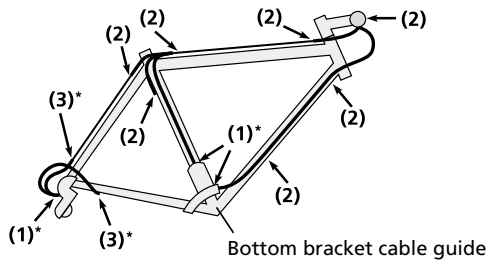

\* Only B can be used for SL-U4010 and SL-U4000.





Type of outer cap		Remarks
A	Sealed outer cap (aluminum type)	FD / RD side Recommended when the outer casing moves to a large degree, such as in bicycles with suspension frames
B	Sealed outer cap (resin type)	Shifter / FD / RD side
C	Sealed outer cap with tongue	Outer casing holder on frame side
D	Rubber shield	

- Before using LINKGLIDE products, check the combinations listed in the compatibility information. Please refer to this link for compatibility information.

The actual product may differ from the illustration because this manual is intended mainly to explain the procedures for using the product.

# List of tools to be used

The following tools are needed for installation/removal, adjustment, and maintenance purposes.

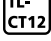
Tool	
	2 mm hexagon wrench
	2.5 mm hexagon wrench
	4 mm hexagon wrench
	5 mm hexagon wrench
	Cross head screwdriver [#2]
	TL-CT12

# Installation/removal

## Installing the shifter

When installing parts onto a carbon frame/handlebar, confirm the recommended tightening torque with the carbon frame or handlebar manufacturer. This will prevent damage to the frame/handlebar due to over-torquing or inadequate securing of the components.

### Standard type

#### 1. Tighten the fixing screw.

Use a handlebar grip with a maximum outer diameter of  $\varnothing 36$  mm or less.

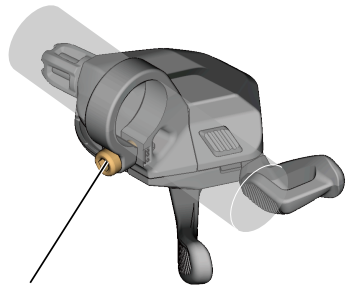

**4** 3 N·m  
(SL-U8000)

**5** 5 N·m  
(SL-U6000 / SL-U4010 / SL-U4000)

Fixing screw

### **NOTICE**

- Check that the brake and gear shifting operations are not obstructed.

### I-SPEC II (SL-U8000-IL / SL-U8000-11IR)

For information on brake levers that can be installed, check the compatibility information (<https://productinfo.shimano.com>).



# Installation/removal

## Installing the shifter

---

### 1. Open the clamp band of the brake lever.

- (1) Loosen the fixing screw.
- (2) Press the recessed area of the clamp band with a tool such as a 2 mm hexagon wrench to disengage the safety latch.

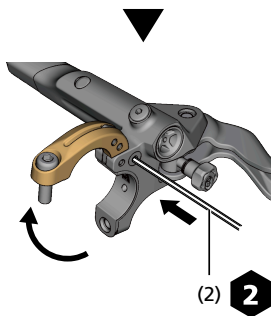
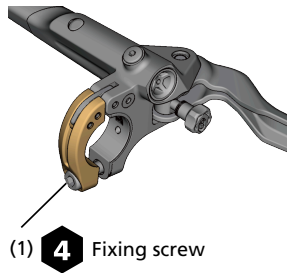

### 2. Remove the band adapter on the inner side of the clamp band.

Remove any remaining adhesive.

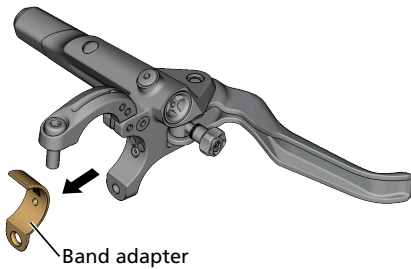

3. Set the shifter bracket onto the brake lever bracket.

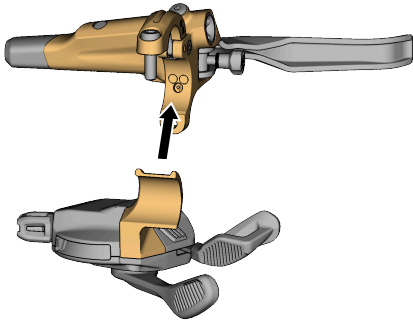

4. Install to the handlebar and adjust the position of the shifter.  
Adjust the shifter by sliding it vertically.

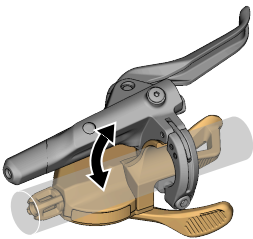

5. Secure the clamp band of the brake lever.  
Secure the lever using the fixing screw.

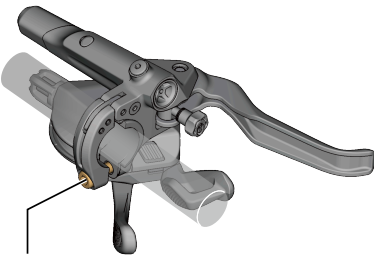

**4** 4 - 6 N·m

Fixing screw

# Adjustment

## Adjusting the stopped lever position (RAPIDFIRE PLUS MONO lever)

The stopped lever position can be adjusted. After lever operation, the lever is kept in the adjusted position. If the lever is operated again, the lever returns to its initial position.

## Adjustment

### Adjusting the stopped lever position (RAPIDFIRE PLUS MONO lever)

#### **⚠ CAUTION**

- Adjusting the stopped lever position must only be done after returning the lever to its initial position. If the adjuster is moved during lever operation, the lever may be damaged.

## SL-U8000

### 1. Turn the adjuster while pushing it towards the lever body.

The stopped lever position changes based on the position of the recessed area of the adjuster.

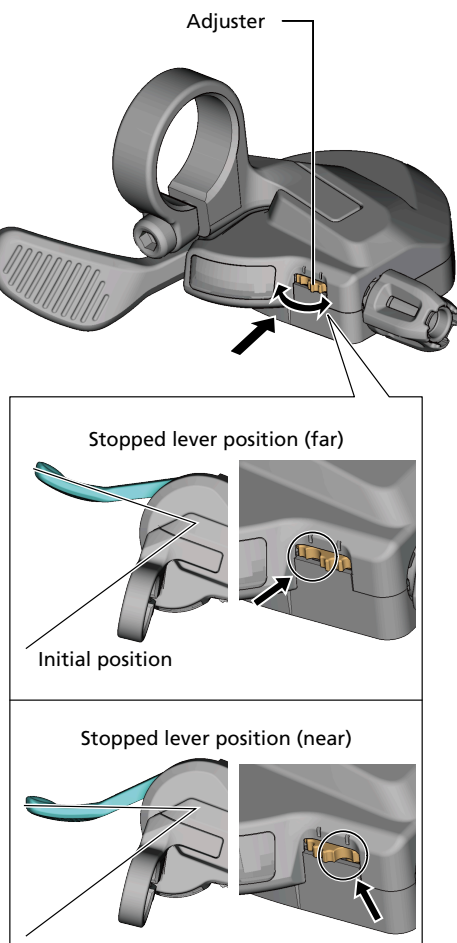

# Maintenance

## Replacing the inner cable

Before starting the replacement, loosen the fixing fastener of the inner cable on the front derailleur and rear derailleur.

### Shifter

#### SL-U8000

- 1. Set the shifter in its initial position.**  
Operate the release lever 10 times or more.
- 2. Slide open the inner hole cap.**

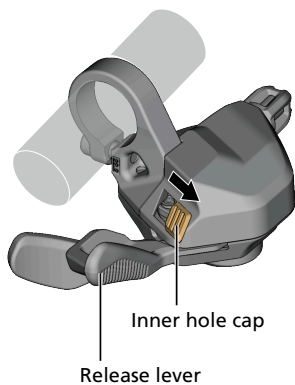

## Maintenance

### Replacing the inner cable

---

3. Replace the inner cable and slide the inner hole cap closed.

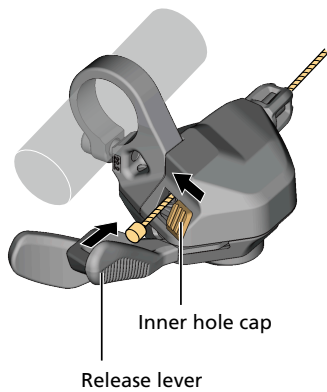

### SL-U6000 / SL-U4010 / SL-U4000

1. Set the shifter in its initial position.

Operate the release lever 10 or more times for an 11-speed, 9 or more times for a 10-speed, and 8 or more times for a 9-speed.

2. Remove the inner hole cap.

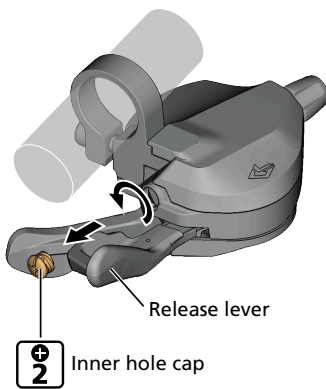

## Maintenance

### Replacing the inner cable

---

#### 3. Replace the inner cable and install an inner hole cap.

Turn and stop the inner hole cap at the position shown in the figure. If you force it to turn, it may damage the screw thread on the cap.

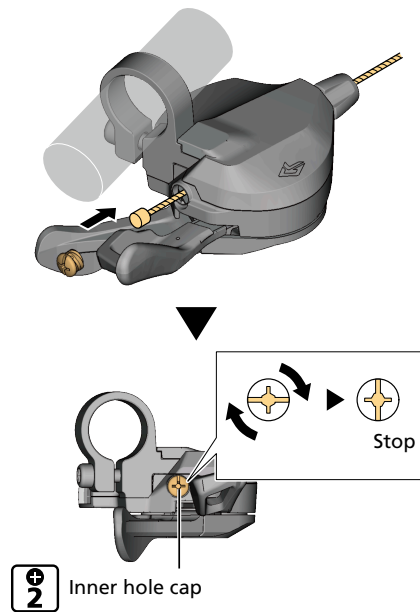

## Shifter (RAPIDFIRE PLUS MONO lever)

SL-U8000-L / SL-U8000-IL

#### 1. Set the lever in its initial position.

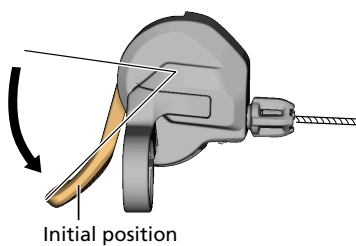

### 2. Loosen the cover fixing screw.

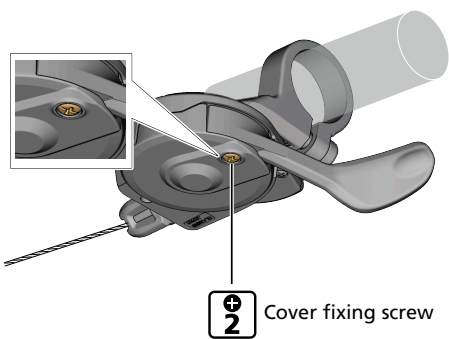

### 3. Move the cover and remove the inner cable.

The cover does not completely come off. Remove the inner cable from the gap made by moving the cover.

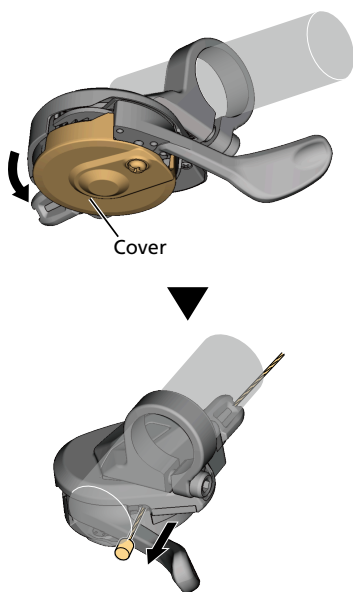

### **NOTICE**

- Pulling on the cover forcibly may cause damage to the drop prevention tab.



4. Install the inner cable.

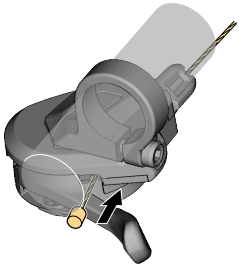

5. Install the cover in the reverse order of disassembly.

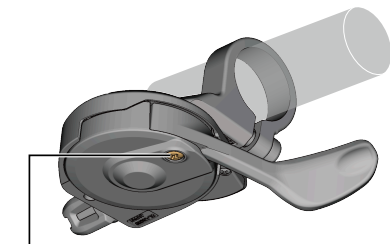
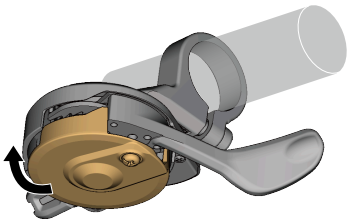

**2** 0.3 N·m  
Cover fixing screw

SL-U6000-L / SL-U4000-L

1. Set the lever in its initial position.

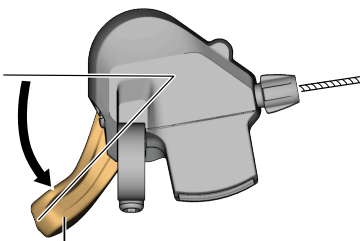

Initial position

**2. Remove the inner hole cap.**

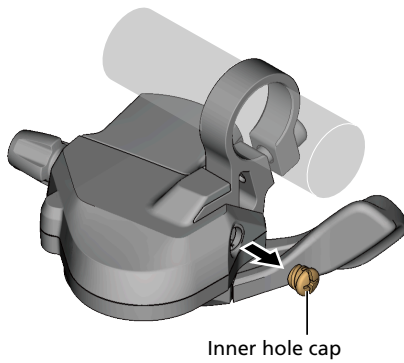

**3. Replace the inner cable and install an inner hole cap.**

Turn and stop the inner hole cap at the position shown in the figure. If you force it to turn, it may damage the screw thread on the cap.

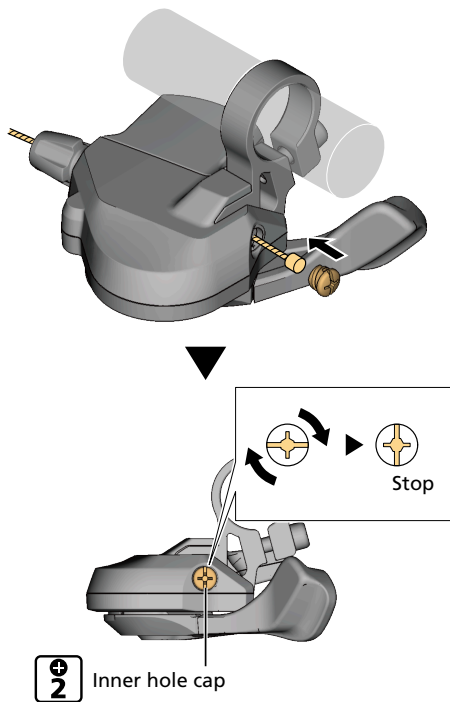

## Replacing the cover

Disassembly and assembly should only be conducted when replacing the shifter.

\* The cover of the RAPIDFIRE PLUS MONO lever cannot be replaced.

**⚠ CAUTION**

- When removing the cover, wear gloves and gradually apply force. A sudden release of resistance on the cover may cause injury.

SL-U8000

1. Remove the cover fixing screw.



### 2. Remove the cover.

\* When installing the cover, reverse the procedure.

- (1) Remove the snap fits on the cover in order from (A).

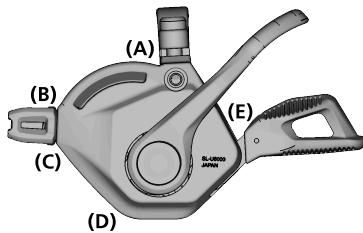

- (2) Pull the top and bottom covers of the snap fit (B) part to remove the snap fit (B). Do the same for snap fits (C) and (D).

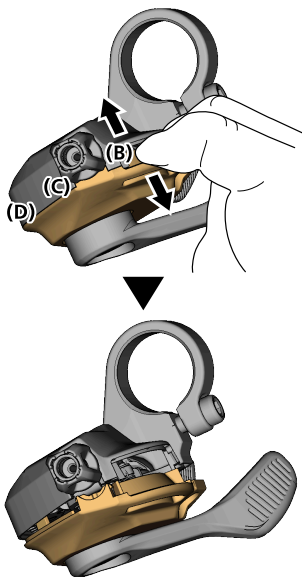

### **NOTICE**

- Do not touch the needle of the indicator. If this is not observed, problems with operation may occur.

## Maintenance

### Replacing the cover

---

- (3) Lift up the top cover, and remove the claw in (E) from the bracket.

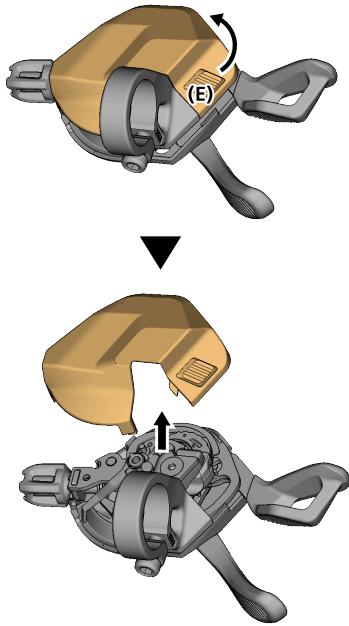

#### **NOTICE**

- When removing the cover, do not apply excessive force. Doing so may damage the snap fit and the claw.

---

# SHIMANO

**SHIMANO NORTH AMERICA BICYCLE, INC.**  
One Holland, Irvine, California 92618, U.S.A. Phone: +1-949-951-5003

**SHIMANO EUROPE B.V.**  
High Tech Campus 92, 5656 AG Eindhoven, The Netherlands Phone: +31-402-612222

**SHIMANO INC.**  
3-77 Oimatsu-cho, Sakai-ku, Sakai City, Osaka 590-8577, Japan

Please note: specifications are subject to change for improvement without notice. (English)  
© Feb. 2023 by SHIMANO INC. ITP